

 FUEL MANAGEMENT
 SYSTEMS

DISPENSERS



KITS



PUMPS



METERS



NOZZLES

FUEL & BIOFUEL

FEATURES

- BURSTING PRESSURE 10 BAR
- REPLACEABLE CARTRIDGE
- HIGH EFFICIENCY
- SMALL SIZE

Among its range of filters, PIUSI has developed the FUEL&BIOFUEL FILTER: cartridge and water absorbing filters that prevent fluid contamination thanks to their improved filtration capacity up to 30µ.

PERFORMANCE

| | |
|---------------------------------------|---------------------------------------|
| UP TO 100 L/MIN | 3,5 BAR MAX |
| FLOW RATE | OPERATING PRESSURE |
| FILTERING CAPACITY 200β/10µ | FILTERING CAPACITY 2β/5-10µ |
| BIOFUEL | FUEL |

BIO-FUEL FILTER

OIL AND FUEL FILTER

LINE FILTER 1-1

PACKAGING

| CODE | WEIGHT | DIMENSIONS MM | PACKAGING | |
|---------------------------------|--------|------------------|------------------------|------------------------|
| | KG | | CARTRIDGE PSC / BOX | FILTER HEAD PCS/BOX |
| BIOFUEL FILTERS | | | | |
| FO0611COO | 2 | 390X285X140 | 2 | 1 |
| FO0611C10 | 1,9 | 390X285X140 | 1 | 1 |
| BIOFUEL FILTER CARTRIDGE | | | | |
| F14861000 | - | - | 1 | - |
| FUEL FILTERS | | | | |
| FO77200A | 1 | 200X120X140 | 1 | 1 |
| F914900B | 2,6 | 390X285X140 | 1 | 1 |
| FUEL FILTERS CARTRIDGE | | | | |
| FO935900A | - | - | 1 | - |
| F16483010 | 9,2 | 500X300X200 | 15 | - |
| FILTER HEAD | | | | |
| F14528000 | - | - | - | 1 |
| INLINE FILTER | | | | |
| FO8950000 | - | - | - | - |

FILTRATION

TANK MONITORING



HOSE REEL



ACCESSORIES



MERCHANDISE

INDEX

ANY BIODIESEL

AIR

ANTIFREEZE

AdBlue®

BIODIESEL

DIESEL

FOOD

GASOLINE

GREASE

KEROSENE

OIL

WATER

WINDSCREEN

DIMENSIONS

 A B C D F
 (MM) (MM) (MM) (MM)

FILTER FOR BIOFUEL

| | | | | | |
|-----------|-----|-----|-----|-----|-------------------------------|
| FO0611C00 | - | 100 | 275 | 95 | - |
| FO0611C10 | - | 171 | 340 | 130 | - |
| F14861000 | 220 | - | - | 95 | 1" - 12 UNF |
| R14862000 | 275 | - | - | 130 | 1" 1/2 - 16 UNF |
| F14640000 | - | 100 | - | - | 1" - 12 UNF |
| F15743000 | - | 171 | - | - | 1" 1/2 - 16 UNF 1" 1/4 BSP |

FILTER FOR FUEL AND OIL

| | | | | | |
|-----------|-----|-----|-----|-----|-------------------------------|
| FO777200A | - | 100 | 160 | 98 | - |
| FO914900A | - | 171 | 236 | 132 | - |
| FO9149020 | - | 171 | 236 | 132 | - |
| FO0611000 | 145 | - | - | 98 | 3/4" BSP |
| FO9359000 | 180 | - | - | 132 | 1" 1/4 BSP |
| FO9359010 | 180 | - | - | 132 | 1" 1/4 BSP |
| F14528000 | - | 100 | - | - | 3/4" BSP |
| F15743000 | - | 171 | - | - | 1" 1/2 - 16 UNF 1" 1/4 BSP |
| F16483010 | 139 | - | - | 93 | 3/4" BSP |

LINE FILTER

| | | | | | |
|-----------|---|---|---|---|---|
| FO8950000 | - | - | - | - | - |
|-----------|---|---|---|---|---|

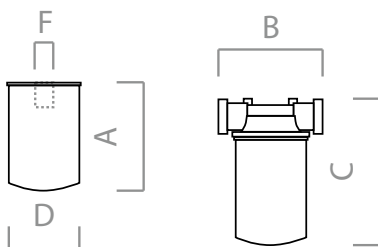
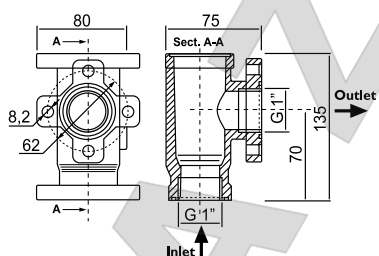
BIO-FUEL / OIL AND FUEL FILTERS

LINE FILTER 1-1

Dimensions expressed in millimeters

IN THE BOX

- FILTER CARTRIDGE
- METALLIC HEAD
- ADDITIONAL CARTRIDGE
- INSTRUCTION MANUAL

DETAILS

FILTER HEAD

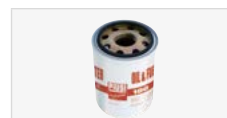

REPLACEABLE CARTRIDGE



MESH STRAINER



LINE FILTER

MATERIALS

- FILTER: ABSORBENT FILTERING PAPER

TECHNICAL DATA

| CODE | DESCRIPTION | FLUIDS TYPE | FLOW RATE | | INLET / OUTLET BSP | WATER ABSORBING | EFFICIENCY β | MICRO μm | PRESSURE BAR |
|---------------------------------|---|-------------|-----------|------|-----------------------|--------------------|-----------------|-------------|-----------------|
| | | | L/MIN | GPM | | | | | |
| BIOFUEL FILTERS | | | | | | | | | |
| FO0611C00 | BIO-FUEL FILTER 70 L/MIN 1"X1" | B G | 70 | 18,5 | 1" | YES | 200 | 10 | 3,5 |
| FO0611C10 | BIO-FUEL FILTER 100 L/MIN 1"X1" | B G | 100 | 26,4 | 1" | YES | 200 | 10 | 3,5 |
| BIOFUEL FILTER CARTRIDGE | | | | | | | | | |
| F14861000 | CARTRIDGE 70 L/MIN BIO-FUEL | B G | 70 | 19,5 | - | YES | 200 | 10 | FUEL |
| FUEL FILTERS | | | | | | | | | |
| FO777200A | 60 L/MIN FILTER WITH HEAD | B D G O | 60 | 15,9 | 1" | NO | 2 | 10 | 12 |
| FO914900B | 100 L/MIN FILTER WITH HEAD | B D G O | 100 | 26,4 | 1" | NO | 2 | 10 | 12 |
| FUEL FILTERS CARTRIDGE | | | | | | | | | |
| FO935900A | CARTRIDGE 100 L/MIN | B D G O | 100 | 26,4 | - | NO | 2 | 10 | 12 |
| F16483000 | CARTUCCIA 10 MIC FILTRO 3/4" IN PIUSI_BOX | B D G O | 60 | 15,9 | - | NO | 2 | 10 | 12 |
| FILTER HEAD | | | | | | | | | |
| F14528000 | FILTER HEAD 3/4 BSP 60 L/MIN | B D G O | - | - | 1" | NO | - | - | - |
| INLINE FILTER | | | | | | | | | |
| FO8950000 | LINE FILTER | B D G O | - | - | 1" | NO | - | - | - |

FUEL & BIOFUEL